



QicTrims UK & Middle East

GLOBAL ALUMINIUM PROFILES

QicTrims Ltd



QIC Evolution

Frameless Glazed Partitioning System

UK Approved Acoustic Performance



INTERIOR GLAZED SOLUTIONS

Leading suppliers of aluminium profiles and ancillary products for commercial interior fit-outs

The QIC Evolution glazed partitioning system has been designed to be virtually frameless with the minimum possible aluminium head and base track



British Manufacturer



QicTrims UK & Middle East

GLOBAL ALUMINIUM PROFILES



SINGLE GLAZED SYSTEM

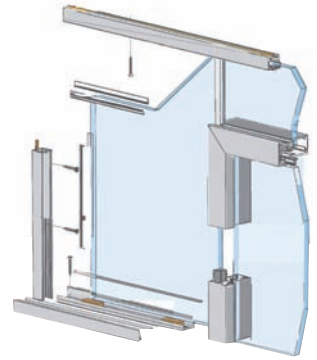

PRODUCT INFORMATION

The interior range of QIC Evolution glazing solutions aims to complement unique design projects covering a diverse range of environments. The range can be incorporated with timber components to provide bespoke solutions. This component based system is ready to use, with patented variants, and it's in stock now!



QIC Evolution systems give designers and architects the opportunity to create environments that are imaginative and visually impressive.

- Unique patented design
- Exclusively available from QIC
- Slim minimalist appearance giving a near seamless look
- Flexible design able to accommodate a range of applications including single and double glazed, faceted and curved glass
- Maintains glazed screen acoustic performance
- Single product solution for all standard glass to glass junctions
- Fast and easy to install



SINGLE GLAZED SYSTEM

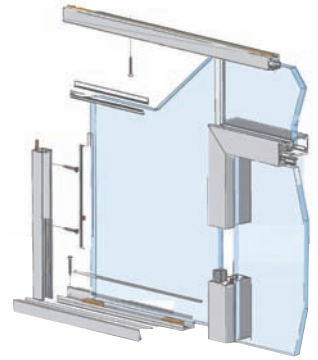

SYSTEM OVERVIEW

Currently available in single glazed and double glazed variants.
 Laminate & acoustic glass tested @ 10mm 12mm 10.8mm & 12.8mm
 Acoustic rating from dB starting at 34dB ranging to 46dB
 All RAL colours available plus satin anodised finish
 Available in both glass and timber door with recessed hinges
 Ironmongery available to suit all individual demands
 Manifestation services also available

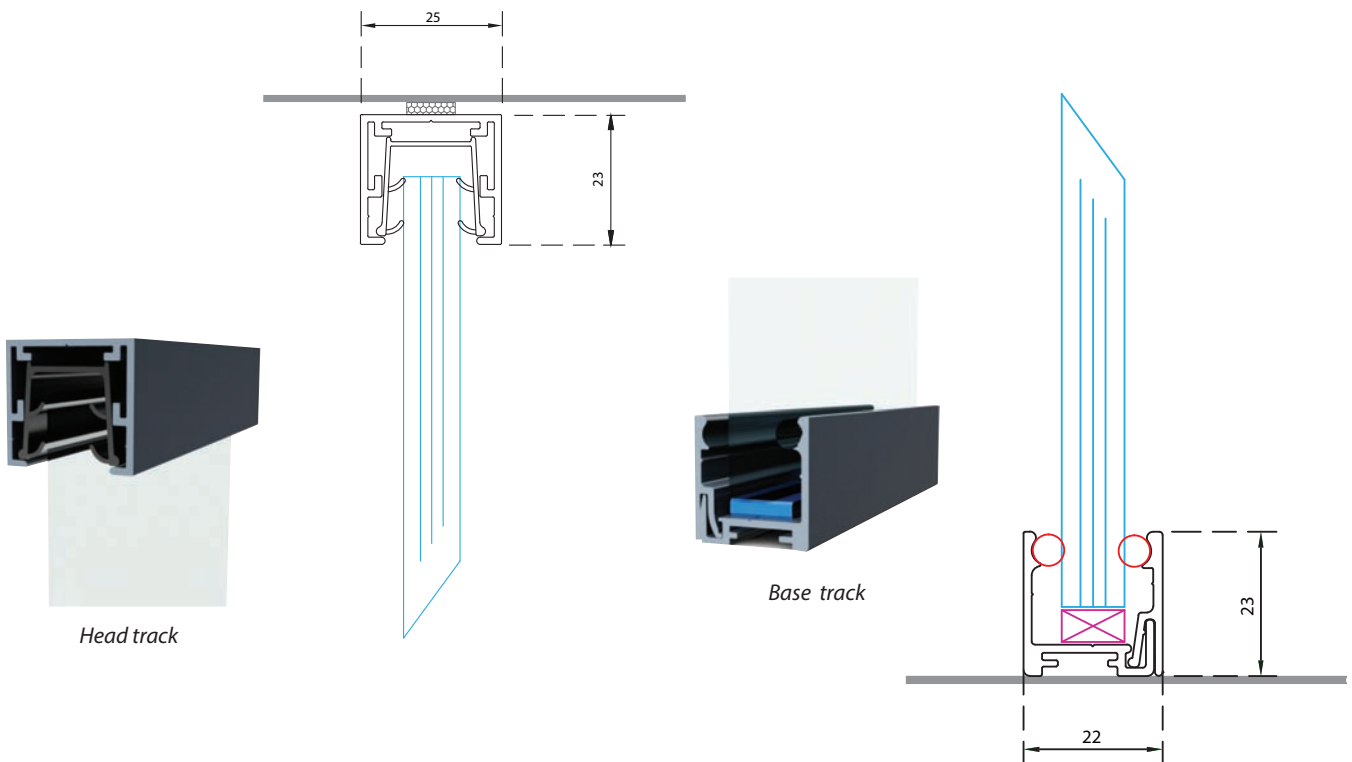



Glass door frame



Timber door frame

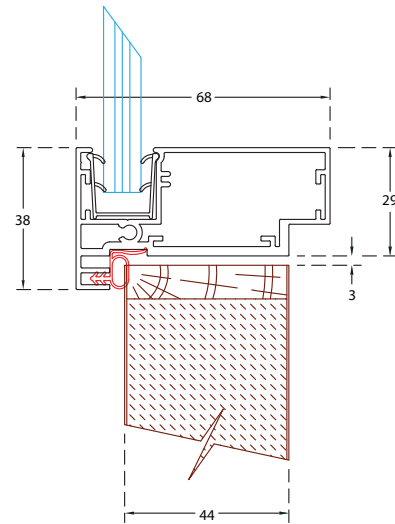
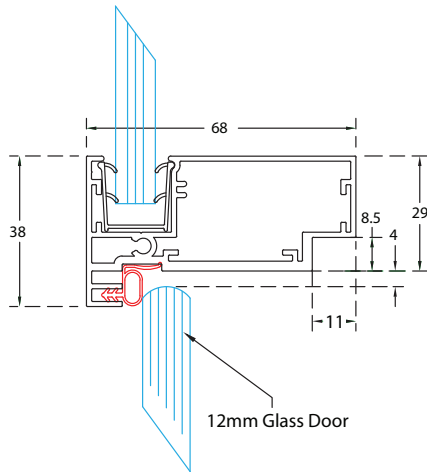



DOUBLE GLAZED SYSTEM

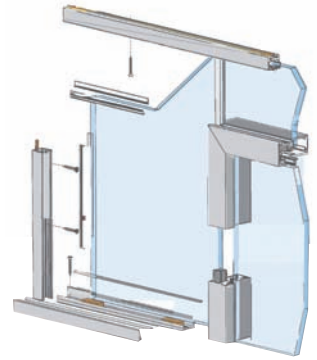

PRODUCT INFORMATION

The interior range of QIC Evolution glazing solutions aims to complement unique design projects covering a diverse range of environments. The range can be incorporated with timber components to provide bespoke solutions. This component based system is ready to use, with patented variants, and it's in stock now!



Space is always at a premium and the ultra slim sections leave a footprint that is only marginally larger than the glass itself creating an almost frameless appearance.

QIC Evolution systems are designed for the modern environment allowing light to fill every office while providing the feeling of space.

- Unique patented design
- Exclusively available from QIC
- Slim minimalist appearance giving a near seamless look
- Flexible design able to accommodate a range of applications including single and double glazed, faceted and curved glass
- Maintains glazed screen acoustic performance
- Single product solution for all standard glass to glass junctions
- Fast and easy to install



DOUBLE GLAZED SYSTEM

SYSTEM OVERVIEW

Currently available in single glazed and double glazed variants.
 Laminate & acoustic glass tested @ 10mm 12mm 10.8mm & 12.8mm
 Acoustic rating from dB starting at 34dB ranging to 46dB
 All RAL colours available plus satin anodised finish
 Available in both glass and timber door with recessed hinges
 Ironmongery available to suit all individual demands
 Manifestation services also available

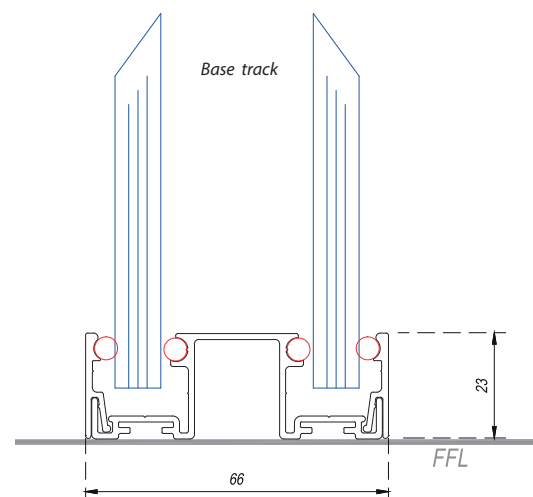
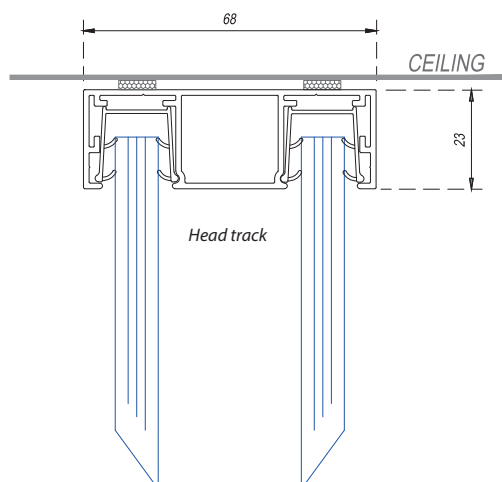



Glass door frame



Timber door frame

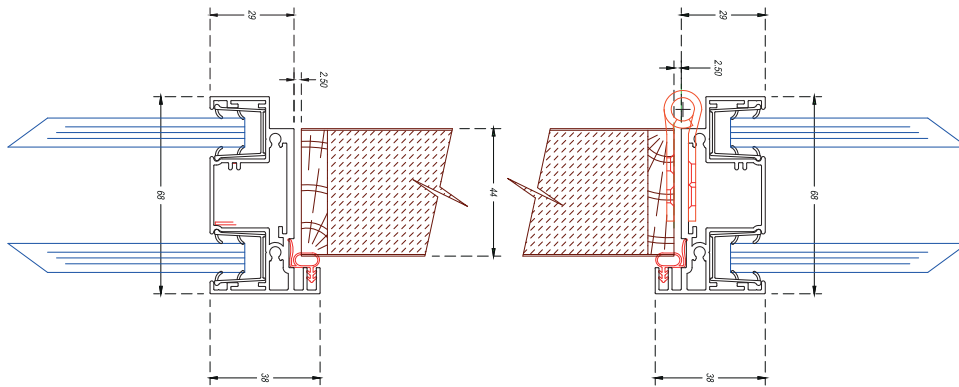

SG01 & SG02 SINGLE GLAZED BASE TRACK

APPLICATION

EVOLUTION SG Single glaze flush look 2 part base track has been designed to sleekly compliment the EVOLUTION partitions system. Designed with single to double transition in mind, the base track height marries into the flush look on the single glaze track alongside single glaze and double glaze door frames. Both inside and outside the office environment the design is clean and visually symmetrical, this gives a flush wall of glass look from the base detail.

PRODUCT INFORMATION

The product is supplied in extrusion length and comes complete with a choice of either 4mm or 5mm clear gasket rod profiles which insert into the base clip in profiles. Aluminium lengths as standard are 3600mm in length, supplied in a standard Mill finish or RAL9010 white / 9006 silver / 9005 black or any other UK RAL or BS colour subject to paint set up conditions, SAA is available on request.

PACKING

Packed in quantities as ordered with no bundle exceeding 25kgs. Packaging is by heavy gauge heat shrink polythene with corrugated cardboard end protection.

TECHNICAL DETAILS

EVOLUTION SG – Single glazed flush look 2 part base track is part of an acoustic tested system providing up to 38dB (Rw) when being used in conjunction with the stated door frame (SGDF) and head /abutment track (SG03) plus all the relevant component gaskets (SG03-PVC) glass clip in, (SG01-4/5BG) track base gasket and (SGDF-BLKG) door rebate gasket parts. Glass scenarios are 10mm & 12mm toughened, acoustic laminated & 10.8 & 12.8mm with glass dry joints. See test evidence for further details.

EVOLUTION SG - Single glaze flush look 2 part base track, has x2 areas for gasket installation, 4mm or 5mm rod is used on the outer clip in profiles dependant on glass thickness installed.

Fitting of the track securely to a solid floor surface is recommended and cleats used in the base on runs of more than one length will be required for flush transition. Glass insulation requires packers to assist with shuffle glazing, head track gaskets are to be lubricated prior to fitting panels.(particularly on 12/12.8mm glass as these are a tighter fit).

This system is currently not fire rated.

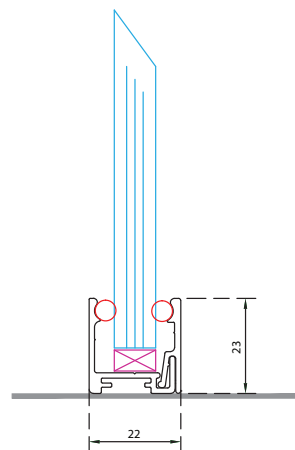



GLASS PARTITIONING DATA SHEET

SG03 SINGLE GLAZED HEAD / ABUTMENT TRACK

APPLICATION

EVOLUTION SG single glazed flush look head / abutment track has been designed to sleekly compliment the EVOLUTION partition system. Designed with single to double transition in mind, the head / abutment height marries into the flush look on the single glaze track alongside single glaze and double glaze door frames. From both inside and outside the office environment, this gives a flush wall of glass look at the head.

PRODUCT INFORMATION

The product is supplied in extrusion length and comes complete with a choice of either clear or black PVC gasket clip in profiles. Lengths as standard are 3600mm, supplied in a standard Mill finish or RAL9010 white / 9006 silver / 9005 black or any other UK RAL or BS colour subject to paint set up conditions, SAA anodised finish is also available upon request.

PACKING

Packed in quantities as ordered with no bundle exceeding 25kgs. Packaging is by heavy gauge heat shrink polythene with corrugated cardboard end protection.

TECHNICAL DETAILS

EVOLUTION SG - Single glazed flush look head / abutment track is part of an acoustic tested system providing upto 38dB (Rw) when being used in conjunction with the stated door frame (SGDF) and base tracks (SG01 & SG02) plus all the relevant component gaskets (SG03-PVC) glass clip in, (SG01-4/5BG) track base gasket and (SGDF-BLKG) door rebate gasket parts. Glass scenarios are 10 & 12mm toughened & 10.8mm laminated & 12.8mm with glass dry joints. See test evidence for more details.

EVOLUTION SG - Single glaze flush look head / abutment track, has x3 recess areas for cleat installations in straight runs or when corner/mitre and 135 degree details are to be used.

Fitting of the track securely requires all cleats to be fixed firmly to give a seamless joint between runs of track work, Glass insulation requires head / abutment gaskets to be lubricated prior to fitting panels, (particularly on 12/12.8mm glass as these are a tighter fit).

This system is currently not fire rated

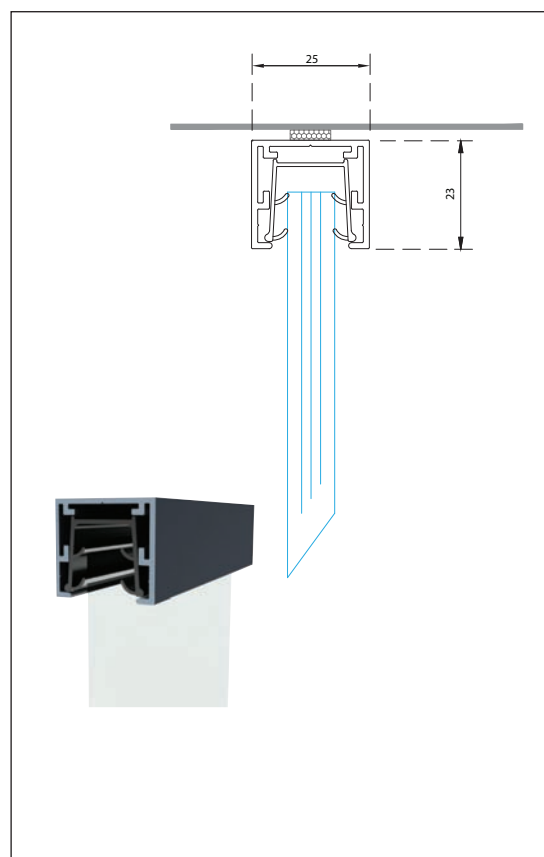

SGDF SINGLE GLAZED DOOR FRAME

APPLICATION

EVOLUTION SG Single glazed flush look door frame has been designed to accept wood or glass door leaves in single and double glaze variant's using a recessed hinge detail in either a standard height or full height requirement. The unique concealed hinge recess provides an eye pleasing transition from door leaf to frame adding to the overall systems aesthetics.

PRODUCT INFORMATION

The product is supplied in a variation of formats, ranging in extrusion only to a very specific bespoke door frame service available to order. Bespoke door frames are supplied as a complete package including all accessories and components required to complete works. Aluminium lengths as standard are 3300mm Long, supplied in a standard Mill finish or RAL9010 white / 9006 silver / 9005 black or any other UK RAL or BS colour subject to paint set up conditions, SAA anodised finish is also available upon request. All accessories required to fit the door frame are available to purchase individually off the shelf when not using the door frame service.

PACKING

Packed in quantities as ordered with no bundle exceeding 25kgs. Packaging is by heavy gauge heat shrink polythene with corrugated cardboard end protection.

TECHNICAL DETAILS

EVOLUTION SG - Single glazed door frame is part of an acoustic tested system providing up to 38dB (Rw) when being used in conjunction with the stated head (SG03) and base tracks (SG01 & SG02) plus all the relevant component gaskets (SG03-PVC) glass clip in, (SG01-4/5BG) track base gasket and (SGDF-BLKG) door rebate gasket parts. Glass scenarios are 10mm & 12mm toughened, 10.8mm acoustic laminated & 12.8mm acoustic laminated.

See test evidence for further details.

Door leaf acoustics is dependable on supplier and cannot be used as evidence without a re-test in the system with said door leaf. The door frame can be used with the traditional EV range of partitioning profiles but a test certificate cannot be offered in these circumstances, however, these profiles are sufficient when a non- acoustic application is required.

Fitting of doors securely require all cleats and screw points fixed firmly on the base of the frames and mitred corners through the top of the head track, Glass insulation requires abutment gaskets to be lubricated prior to fitting panels. (particularly on 12/12.8mm glasses as these are a tighter fit).

This system is currently not fire tested.

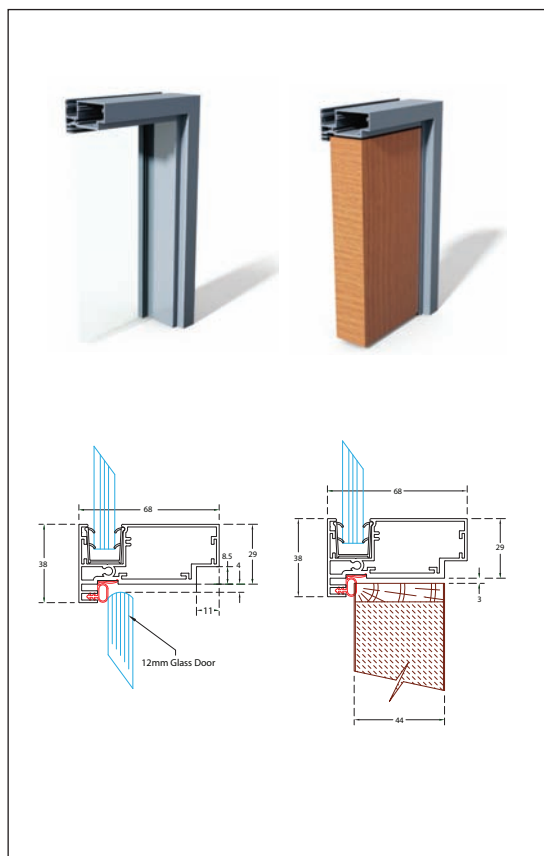



GLASS PARTITIONING DATA SHEET

DG01 & SG01 DOUBLE GLAZED BASE TRACK

APPLICATION

QIC EVOLUTION DG Double glazed flush finish 3 part base track has been designed to sleekly compliment the EVOLUTION partitions system. Designed with single to double transition in mind, the base track height marries into the flush look on the single glazed track alongside single glaze and double glaze door frames. From both inside and outside the office environment, visually this gives a flush wall of glass at the base detail.

PRODUCT INFORMATION

The product is supplied in extrusion length and comes complete with a choice of either 4mm or 5mm clear gasket rod profiles which insert into the base clip in profiles. Aluminium lengths as standard are 3600mm in length, supplied in a standard Mill finish or RAL9010 white / 9006 silver / 9005 black or any other UK RAL or BS colour subject to paint set up conditions, SAA anodised finish is also available upon request.

PACKING

Packed in quantities as ordered with no bundle exceeding 25kgs. Packaging is by heavy gauge heat shrink polythene with corrugated cardboard end protection.

TECHNICAL DETAILS

QIC EVOLUTION DG - Double glazed flush look 3 part base track is part of an acoustic tested system providing a 46dB (Rw) when being used in conjunction with the stated door frame (DGDF) and head /abutment track (DG03) plus all the relevant component gaskets (SG03-PVC) glass clip in, (SG01-4/5BG) track base gasket and (SGDF-BLKG) door rebate gasket. Glass scenarios are 12mm toughened & 12.8mm laminated & 10.8 & 12.8mm with glass dry joints. See test evidence for further details.

QIC EVOLUTION DG - Doubled glazed flush look 3 part base track, has x4 areas for gasket installation, 5mm glazing rod is used in the centre channels, then either 4mm or 5mm rod is used on the outer clip in profiles dependant on glass thickness installed.

Fitting of track securely to a solid floor surface is recommended and cleats used in the base on runs with more than one length will be required for a flush transition. Glass insulation requires packers to assist with shuffle glazing, head track gaskets are to be lubricated prior to fitting panels, (particularly on 12/12.8mm glasses as these are a tighter fit).

This system is currently not fire rated

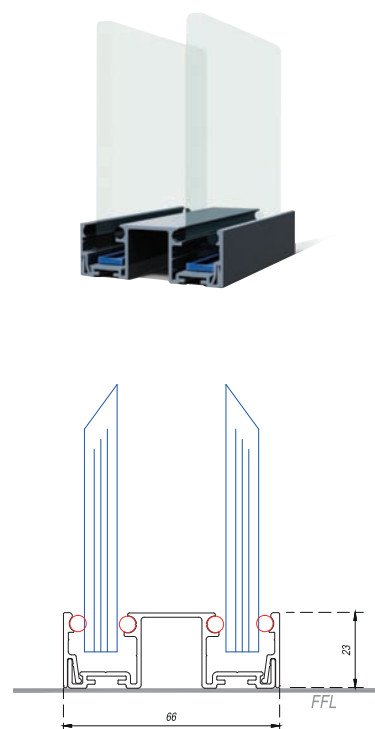

DG03 DOUBLE GLAZED HEAD / ABUTMENT TRACK

APPLICATION

QIC EVOLUTION DG Double glazed flush finish head / abutment track has been designed to sleekly compliment the EVOLUTION partitions system. Designed with single to double transition in mind, the head / abutment height marries into the flush look on the single glazed track along side single glaze and double glaze door frames. From both inside and outside the office environment, visually this gives a flush wall of glass at the head detail.

PRODUCT INFORMATION

The product is supplied in extrusion length and comes complete with a choice of either clear or black PVC gasket clip in profiles. Lengths as standard are 3600mm in length, supplied in a standard Mill finish or RAL9010 white / 9006 silver / 9005 black or any other UK RAL or BS colour subject to paint set up conditions, SAA anodised finish is also available upon request.

PACKING

Packed in quantities as ordered with no bundle exceeding 25kgs. Packaging is by heavy gauge heat shrink polythene with corrugated cardboard end protection.

TECHNICAL DETAILS

QIC EVOLUTION DG - Double glazed flush head / abutment track is part of an acoustic tested system providing a 46dB (Rw) when being used in conjunction with the stated door frame (DGDF) and base tracks (DG01 & SG02) plus all the relevant component gaskets (SG03-PVC) glass clip in, (SG01-4/5BG) track base gasket and (SGDF-BLKG) door rebate gasket. Glass scenarios are 12mm toughened & 12.8mm laminated & 10.8 & 12.8mm with glass dry joints. See test evidence for more details.

QIC EVOLUTION DG - Double glazed flush head / abutment track, has x3 recess areas for cleat installations in straight runs or when corner/mitre and 135 degree details are to be used.

Fitting of track securely requires all cleats fixed firmly to give a seamless joint between runs of track work. Glass insulation requires head / abutment gaskets to be lubricated prior to fitting panels, (particularly on 12/12.8mm glasses as these are a tighter fit).

This system is currently not fire rated.

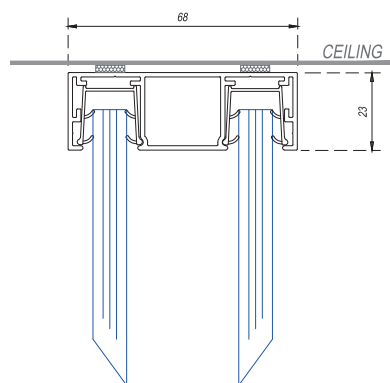



GLASS PARTITIONING DATA SHEET

DGDF DOUBLE GLAZED DOOR FRAME

APPLICATION

QIC EVOLUTION DG Double glazed flush look door frame has been designed to accept wood or glass door leaves in single glazed and double variants using a recessed hinge detail in either a standard height or full height requirement. The unique concealed hinge recess provides an eye pleasing transition from door leaf to frame adding to the overall systems aesthetics.

PRODUCT INFORMATION

The product is supplied in a variation of formats, ranging in extrusion only to a very specific bespoke door frame service available to order. Bespoke door frames are supplied as a complete package including all accessories and components required to complete works. Aluminium lengths are 3300mm Long, supplied in a standard Mill finish or RAL9010 white / 9006 silver / 9005 black or any other UK RAL or BS colour subject to paint set up conditions. SAA anodised finish is also available upon request. All accessories required to fit the door frame are available as standard off the shelf purchases when not using the door frame service.

PACKING

Packed in quantities as ordered with no bundle exceeding 25kgs. Packaging is by heavy gauge heat shrink polythene with corrugated cardboard end protection.

TECHNICAL DETAILS

QIC EVOLUTION DG - Double glazed door frame is part of an acoustic tested system providing a 46dB (Rw) when being used in conjunction with the head (DG03) and base tracks (DG01 & SG02) plus all the relevant component gaskets (SG03-PVC) glass clip in, (SG01-4/5BG) track base gasket and (SGDF-BLKG) door rebate gasket. Glass scenarios are 12mm toughened & 12.8mm laminated & 10.8 & 12.8mm with glass dry joints. See test evidence for further details.

The door leaf acoustics is dependable on supplier and cannot be used as evidence without a re-test in the system.

The door frame can be used with QIC traditional EV range of partitioning profiles but a test certificate cannot be offered in these circumstances. However these profiles are sufficient when a non-acoustic application is required.

Fitting of doors securely require all cleats and screw points fixed firmly on the base of the frames and mitred corners through the top of the head track. Glass insulation requires abutment gaskets to be lubricated prior to fitting panels, (particularly on 12/12.8mm glasses as these are a tight fit).

This system is currently not fire tested

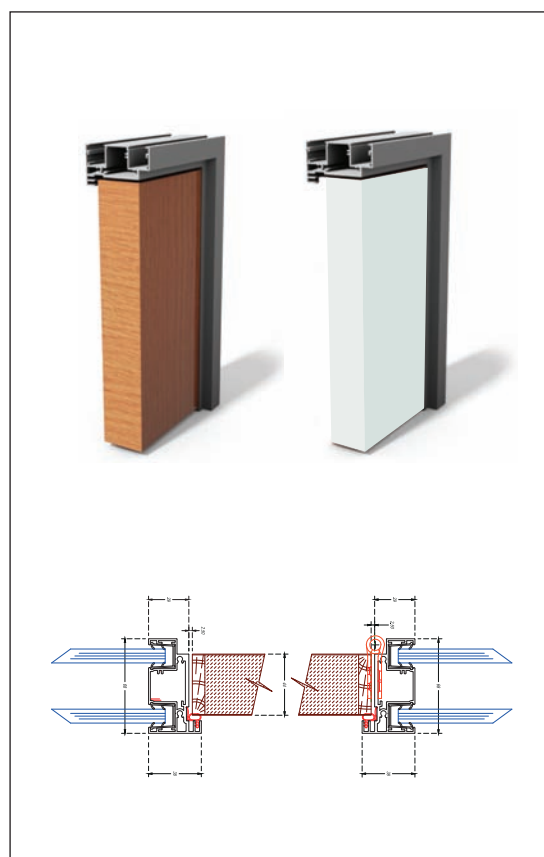



STANDARDS AND ACCREDITATION CERTIFICATION

QIC SG and DG systems are acoustically tested on each glazed fitment with official documentation.

QicTrims Ltd

Sound Reduction
to BS EN ISO 140-3: 1995

Summary of Performance
Document No. SG / 10

Evolution Single Glazed Partitioning System

This is to confirm that the single glazed construction of the above partitioning system using 10mm thick toughened safety glass as detailed in the QIC data sheet, in conjunction with evidence contained in the Building Test Centre Report **BTC 16243AA** (available on request), for measurement of airborne sound insulation of building elements in accordance with BS EN ISO 140-3 and that the resulting Rw measurements are derived from BS EN ISO 717/1.

Glass Area	Weighted Sound Reduction Index 100 - 3150 Hz	Speech Range SRI 400 - 4000 Hz
8.43m ²	33 dB(Rw)	34 dB

For performance validation of the installed product this Summary of Performance must be accompanied by the signed Contractors Statement

QicTrims UK Ltd - 100 Radcliffe Road, Gawcott, Bucks, MK18 4BL (UK)
Phone: 01280 818950 Fax: 01280 818955 www.qic-trims.com

QicTrims Ltd

Sound Reduction
to BS EN ISO 140-3: 1995

Summary of Performance
Document No. DG/10.8-12.8

Evolution Double Glazed Partitioning System

This is to confirm that the double glazed construction of the above partitioning system using 10.8mm and 12.8mm thick acoustic safety glass as detailed in the Building Test Centre Report No. **BTC H18198HA** (available on request), and QIC data sheet has been tested in accordance with BS EN ISO 140-3 for measurement of airborne sound insulation of building elements and that the resulting Rw measurements are derived from BS EN ISO 717/1.

Weighted Sound Reduction Index 100 - 3150 Hz	Speech Range SRI 400 - 4000 Hz
46 dB(Rw)	47 dB

For performance validation of the installed product this Summary of Performance must be accompanied by the signed Contractors Statement

QicTrims UK Ltd - 100 Radcliffe Road, Gawcott, Bucks, MK18 4BL (UK)
Phone: 01280 818950 Fax: 01280 818955 www.qic-trims.com

The full range of certificates are available by request please contact:

QicTrims UK Ltd
 100 Radcliffe Road, Gawcott, Bucks, MK18 4BL (UK)
 Phone: 01280 818950 Fax: 01280 818955
 Email sales@qic-trims.com www.qic-trims.com



ACOUSTIC PERFORMANCE SUMMARY

The following information is a summary of tests carried out in accordance with BS EN ISO 140-3 for measurements of airborne sound insulation of building elements and that the resulting Rw measurements are derived from BS EN ISO 717/1: 1997.

Glass Type / Combination		Glass to Glass Construction	Construction Height	Official Test	Speech Range	BTC Test Certificate No.
Corridor Side	Office Side					
EVOLUTION SINGLE GLAZED (SG)						
10mm Toughened		Dry Joint	3m	33dB	34dB	BTC 16243AA
10.8mm Acoustic						
12mm Toughened		Dry Joint	3.2m	33dB	34dB	BTC 11840A
12.8mm Acoustic						
EVOLUTION DOUBLE GLAZED (DG)						
10mm Toughened	10mm Toughened	Dry Joint	3m	40dB	41dB	H18198BA
12mm Toughened	10mm Toughened	Dry Joint	3.3m	41dB	42dB	H18198CA
12mm Toughened	12mm Toughened	Dry Joint	3m	41dB	42dB	H18198EA
12mm Toughened	10.8mm Acoustic	Dry Joint	3.3m	45dB	46dB	H18198FA
12mm Toughened	12.8mm Acoustic	Dry Joint	3.3m	46dB	47dB	H18198GA
10.8mm Acoustic	12.8mm Acoustic	Dry Joint	3.3m	46dB	47dB	H18198HA

This chart is for guidance and marketing purposes only, please contact QIC for the official Data on test evidence.

The Qic Evolution range is continually under development with additional products coming forward

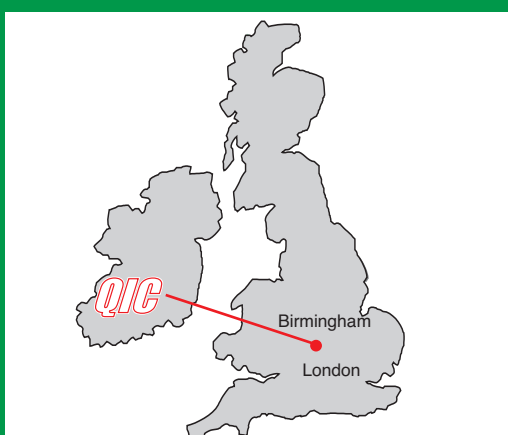
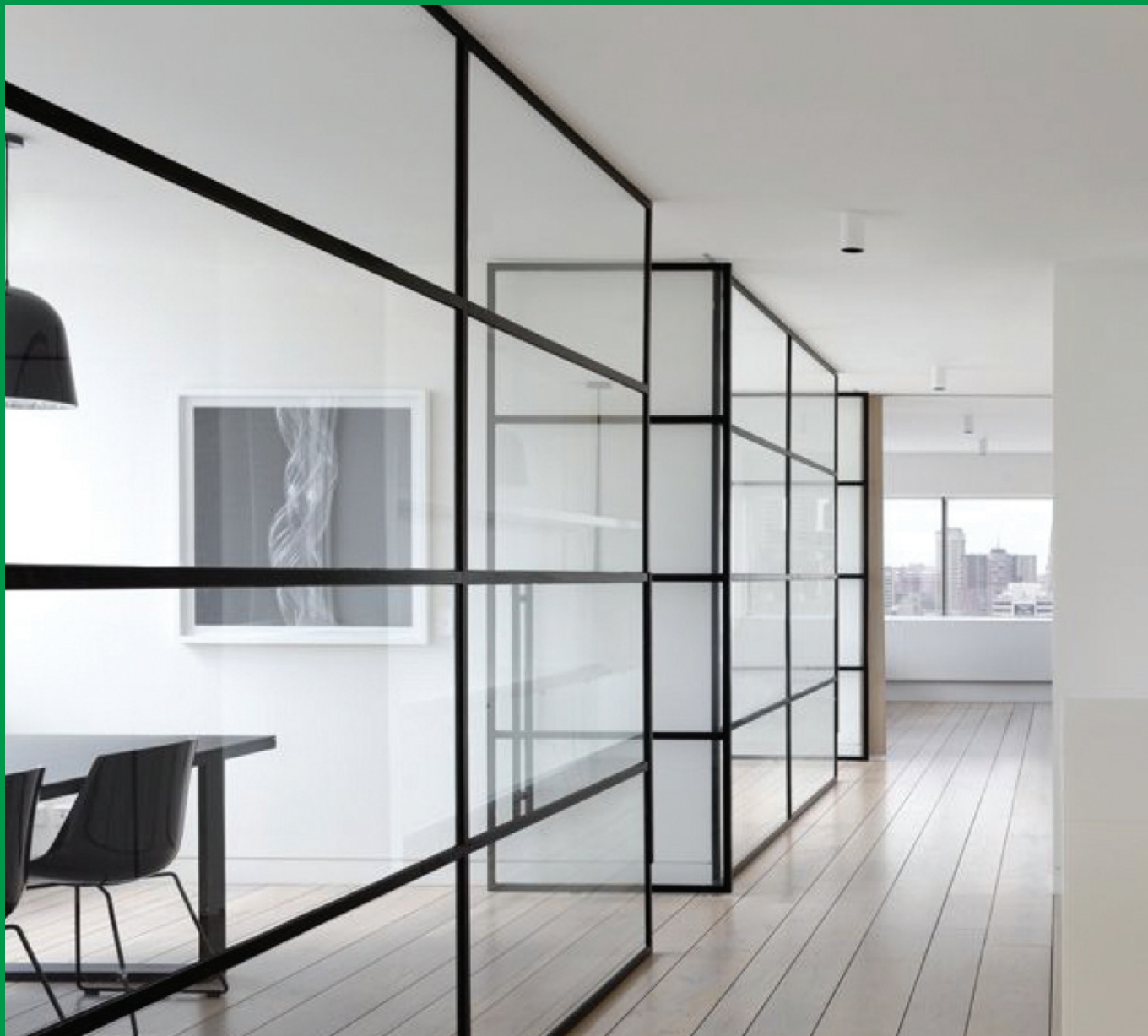

QicTrims UK Ltd - 100 Radclive Road, Gawcott, Bucks, MK18 4BL (UK)

Phone: 01280 818950 Fax: 01280 818955 www.qic-trims.com

QicTrims Middle East, BCW, Jafza View 18 & 19, First Floor, Jebel Ali Free Zone, Dubai, UAE

Tel: +971 4 813 7796 Fax: +971 4 813 7814

www.qic-trims.com