



GLASS PARTITIONING DATA SHEET

Qic Trims Ltd

SGDF SINGLE GLAZED DOOR FRAME



APPLICATION

QIC EVOLUTION SG Single glazed flush look door frame has been designed to accept wood or glass door leaves in single and double glaze variant's using a recessed hinge detail in either a standard height or full height requirement. The unique concealed hinge recess provides an eye pleasing transition from door leaf to frame adding to the overall systems aesthetics.

PRODUCT INFORMATION

The Product is supplied in a variation of formats, ranging in extrusion only to a very specific bespoke door frame service available to order. Bespoke door frames are supplied as a complete package including all accessories and component required to complete works. Aluminium lengths as standard are 3300mm Long, supplied in a standard Mill finish or RAL9010 white / 9006 silver / 9005 black or any other UK RAL or BS colour subject to paint set up conditions, SAA anodised finish is also available upon request. All accessories required to fit the door frame are available to purchase individually off the shelf when not using the door frame service.

PACKING

Packed in quantities as ordered with no bundle exceeding 25kgs. Packaging is by heavy gauge heat shrink polythene with corrugated cardboard end protection.

TECHNICAL DETAILS

QIC EVOLUTION SG - Single glazed door frame is part of an acoustic tested system providing up to 38dB (Rw) when being used in conjunction with the stated head (SG03) and base tracks (SG01 & SG02) plus all the relevant component gaskets (SG03-PVC) glass clip in, (SG01-4/5BG) track base gasket and (SGDF-BLKG) door rebate gasket parts. Glass scenarios are 10mm & 12mm toughened, 10.8mm acoustic laminated & 12.8mm acoustic laminated.

See test evidence for further details.

Door leaf acoustics is dependable on supplier and cannot be used as evidence without a re-test in the system with said door leaf.

The door frame can be used with the traditional QIC EV range of partitioning profiles but a test certificate cannot be offered in these circumstances, however, these profiles are sufficient when a non-acoustic application is required.

Fitting of doors securely require all cleats and screw points fixed firmly on the base of the frames and mitred corners through the top of the head track, Glass insulation requires abutment gaskets to be lubricated prior to fitting panels.(particularly on 12/12.8mm glasses as these are a tighter fit).

This system is currently not fire tested.

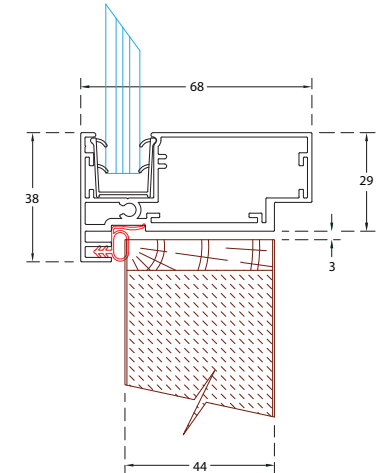
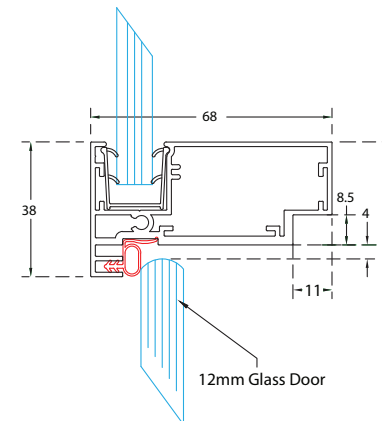

QicTrims UK Ltd - 100 Radclive Road, Gawcott, Bucks, MK18 4BL (UK)
Phone: 01280 818950 Fax: 01280 818955 Email: sales@qic-trims.com

